



GATEWAY ARCH PARK
FOUNDATION





A photograph of the St. Louis skyline at sunset. The Gateway Arch is the central focus, silhouetted against a sky with orange and pink hues. The city skyline is visible behind it, with some buildings lit up. The foreground shows the Mississippi River with reflections of the sky and city lights.

CITIES

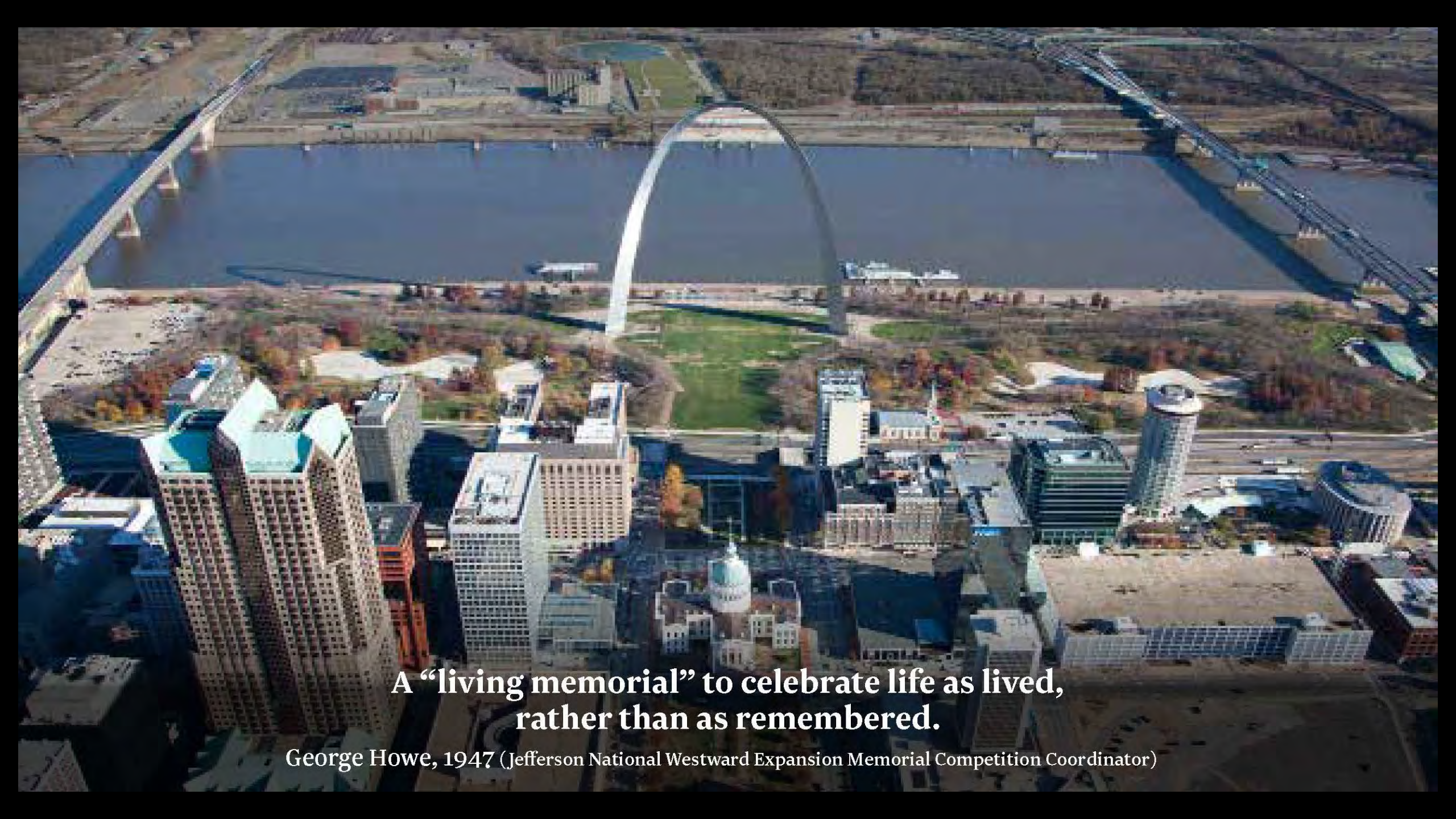

**A “living memorial” to celebrate life as lived,
rather than as remembered.**

George Howe, 1947 (Jefferson National Westward Expansion Memorial Competition Coordinator)



1-70144

MILK BRIDGE

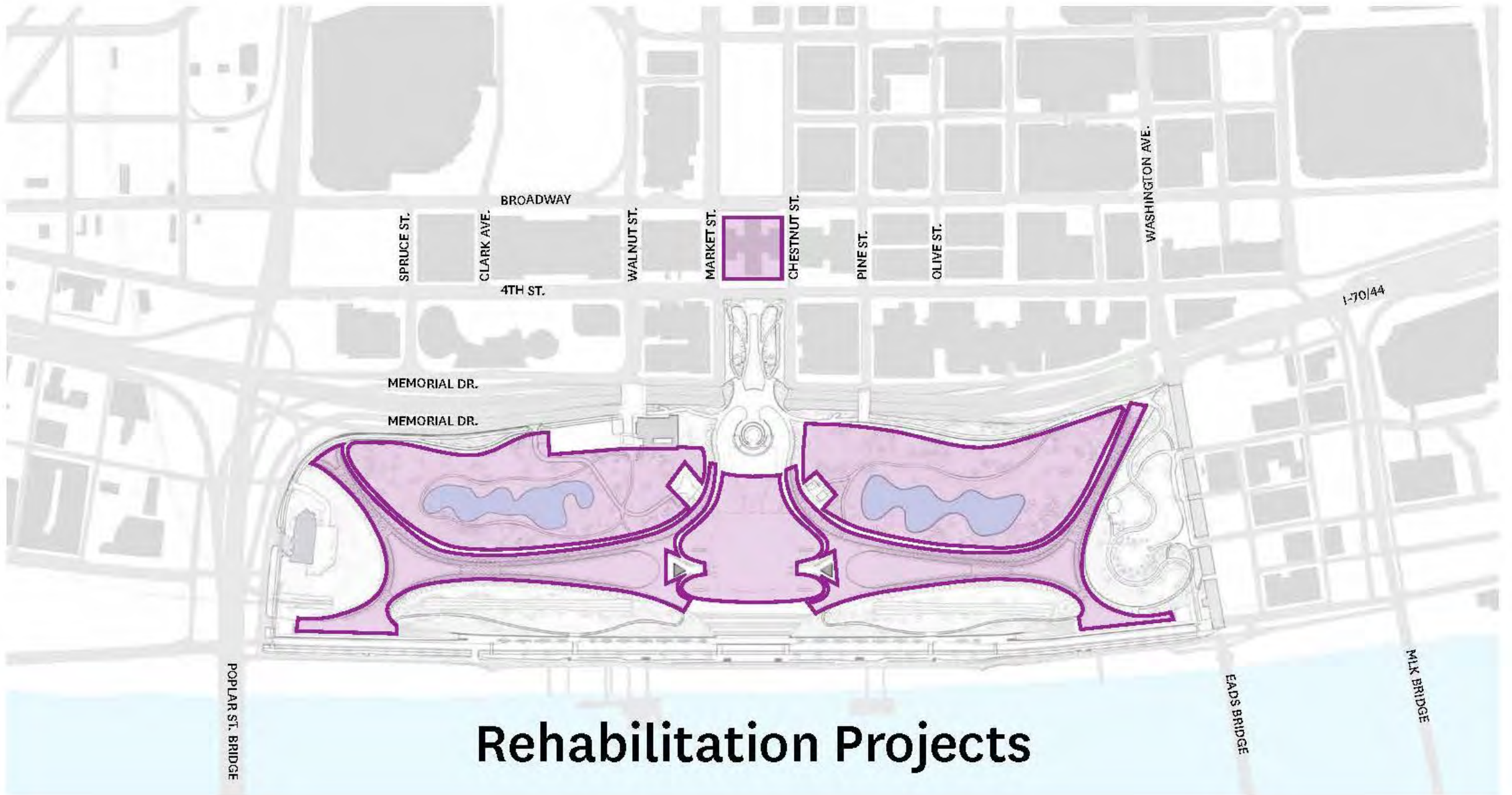

Rehabilitation Projects

1 Luther Ely Smith Square

2 Museum Entry Plaza

3 Urban Trail System

4 North Gateway Event Grounds

5 East Slopes

6 Central Riverfront

7 Kiener Plaza

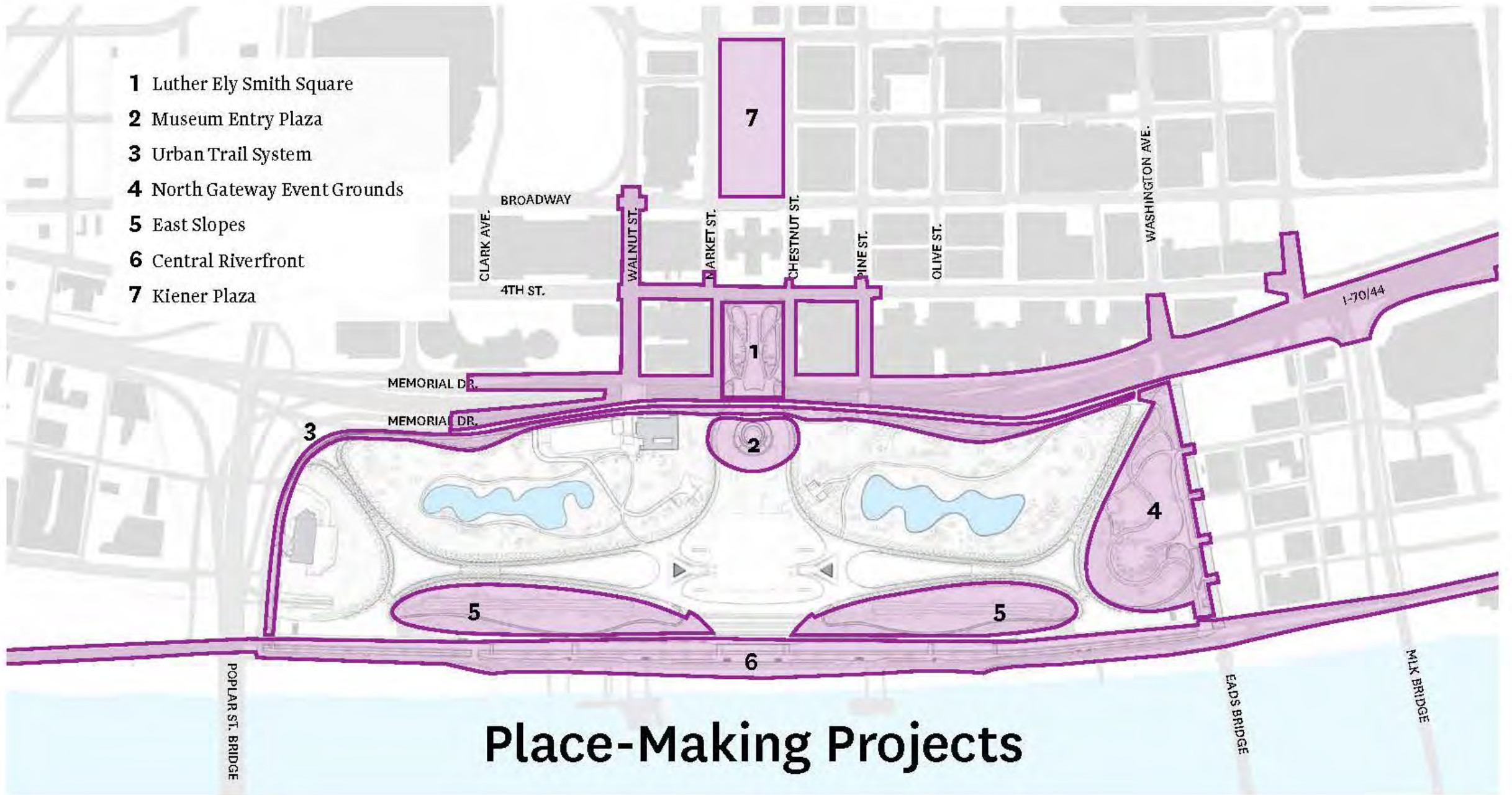

Place-Making Projects

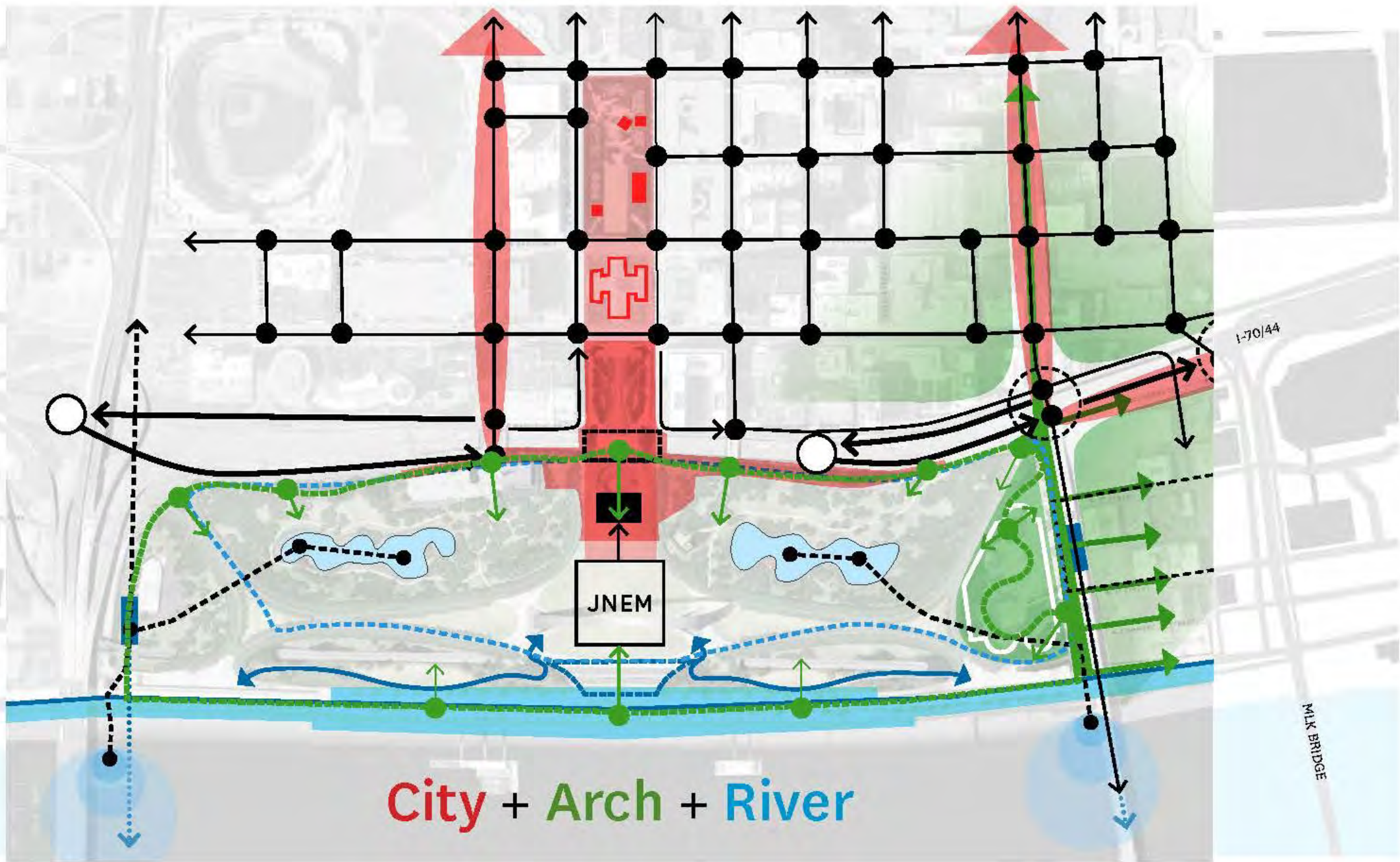

CULTURAL SITES

1. Museum at the Gateway Arch
2. The Old Courthouse & Kiener Plaza
3. Peabody Opera House
4. Soldiers' Memorial Military Museum
5. City Museum
6. Campbell House Museum
7. Field House Museum
8. Busch Stadium
9. The Dome at America's Center
10. Scottrade Center
11. Laclede's Landing
12. Museum at the Federal Reserve
13. Washington Avenue
14. Gateway Mall
15. Citygarden
16. Riverfront Greenway Bike Trail

FESTIVALS

17. Big Muddy Blues Festival
18. Mississippi Nights Music Festival
19. Blues at the Arch
20. Not So Quiet Concert Series
21. PrideFest St. Louis
22. St. Patrick's Day Parade & Run





Connecting to adjacent districts and destinations ...

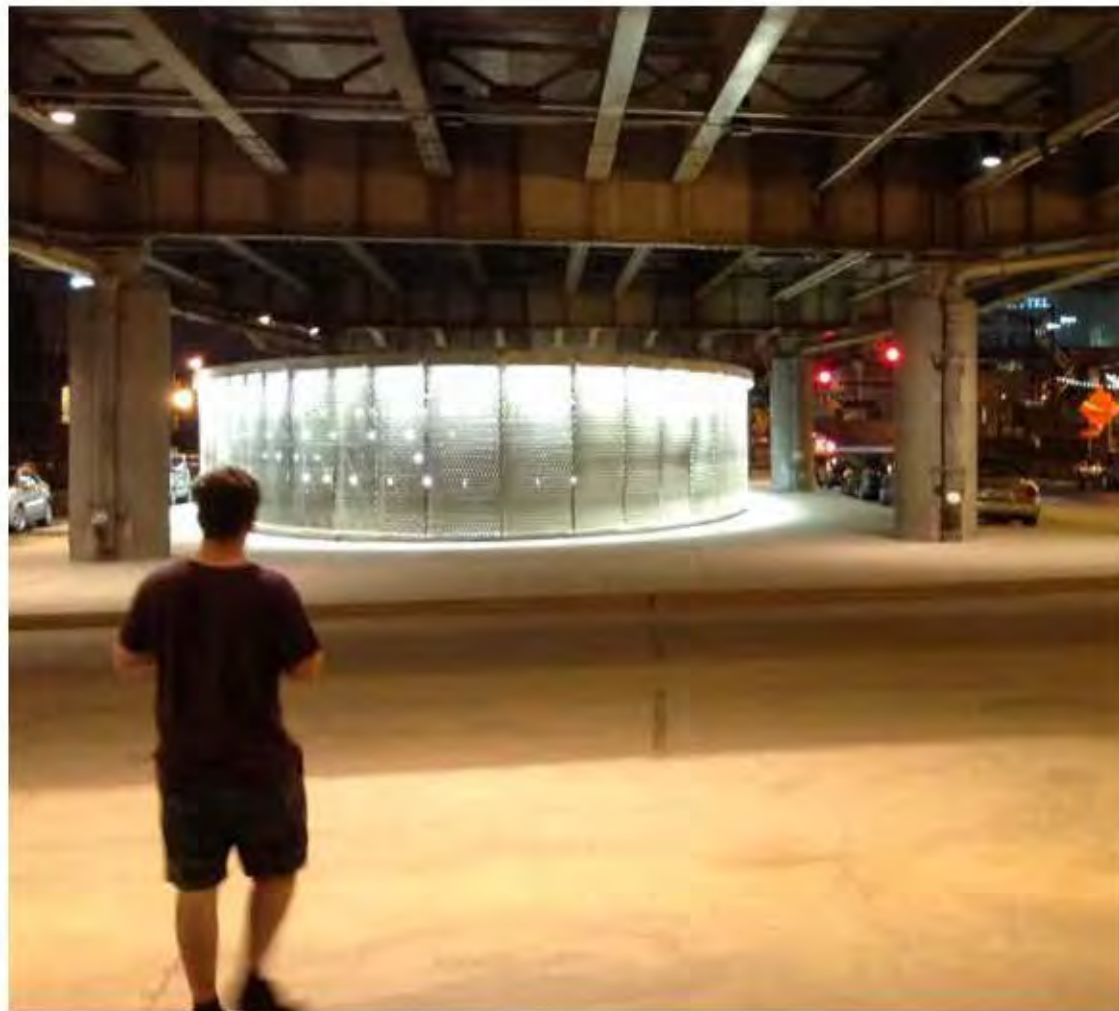

... transforming infrastructure barriers



... inviting passage around and to the Arch



... linking the Arch to the river



... re-animating the riverfront



... and creating a new gateway to St. Louis



... and people are already coming

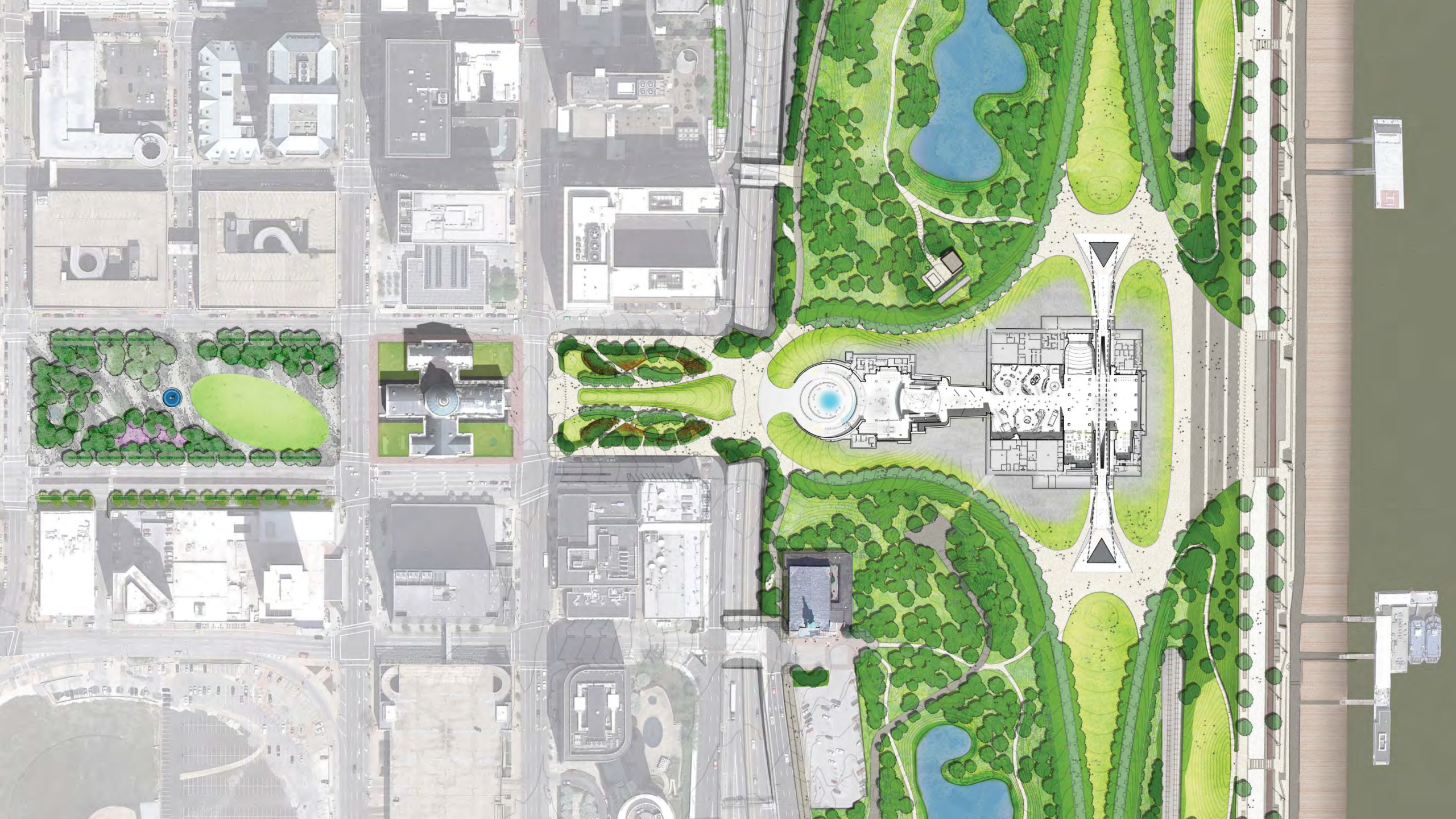



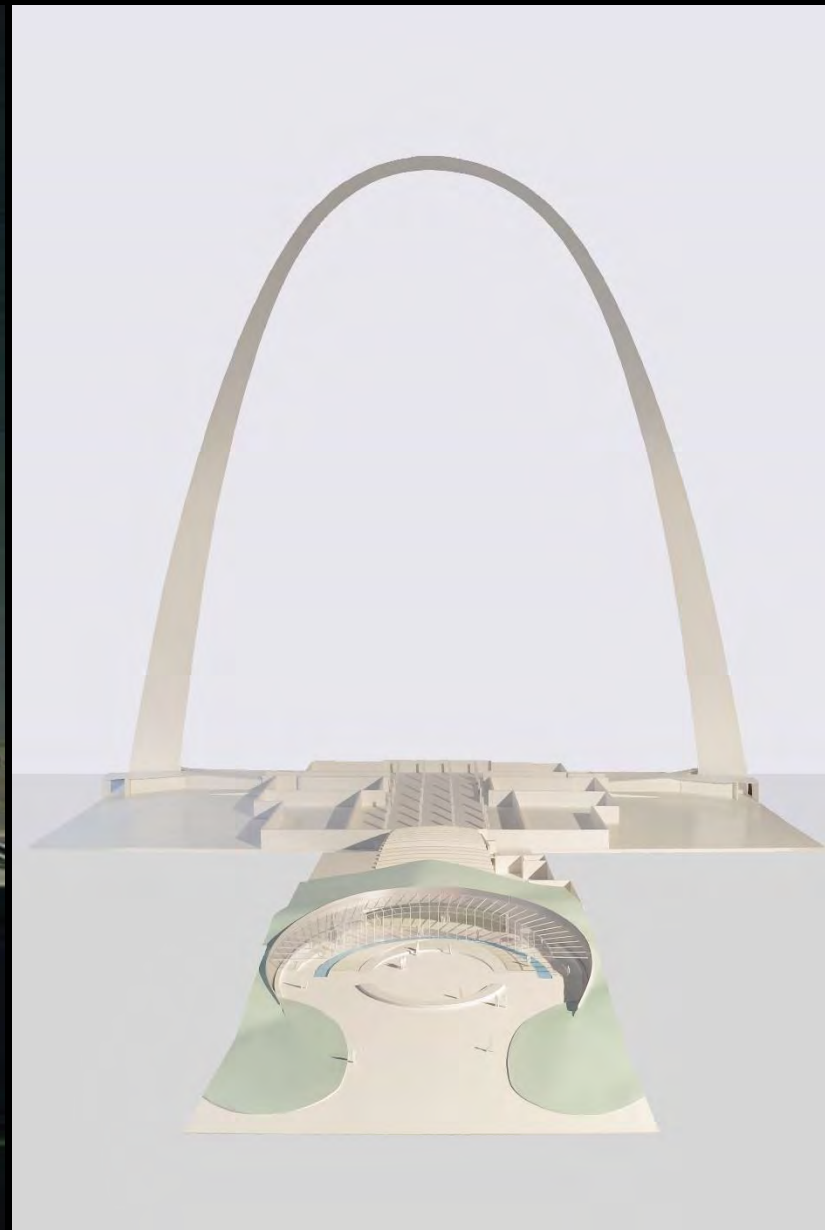

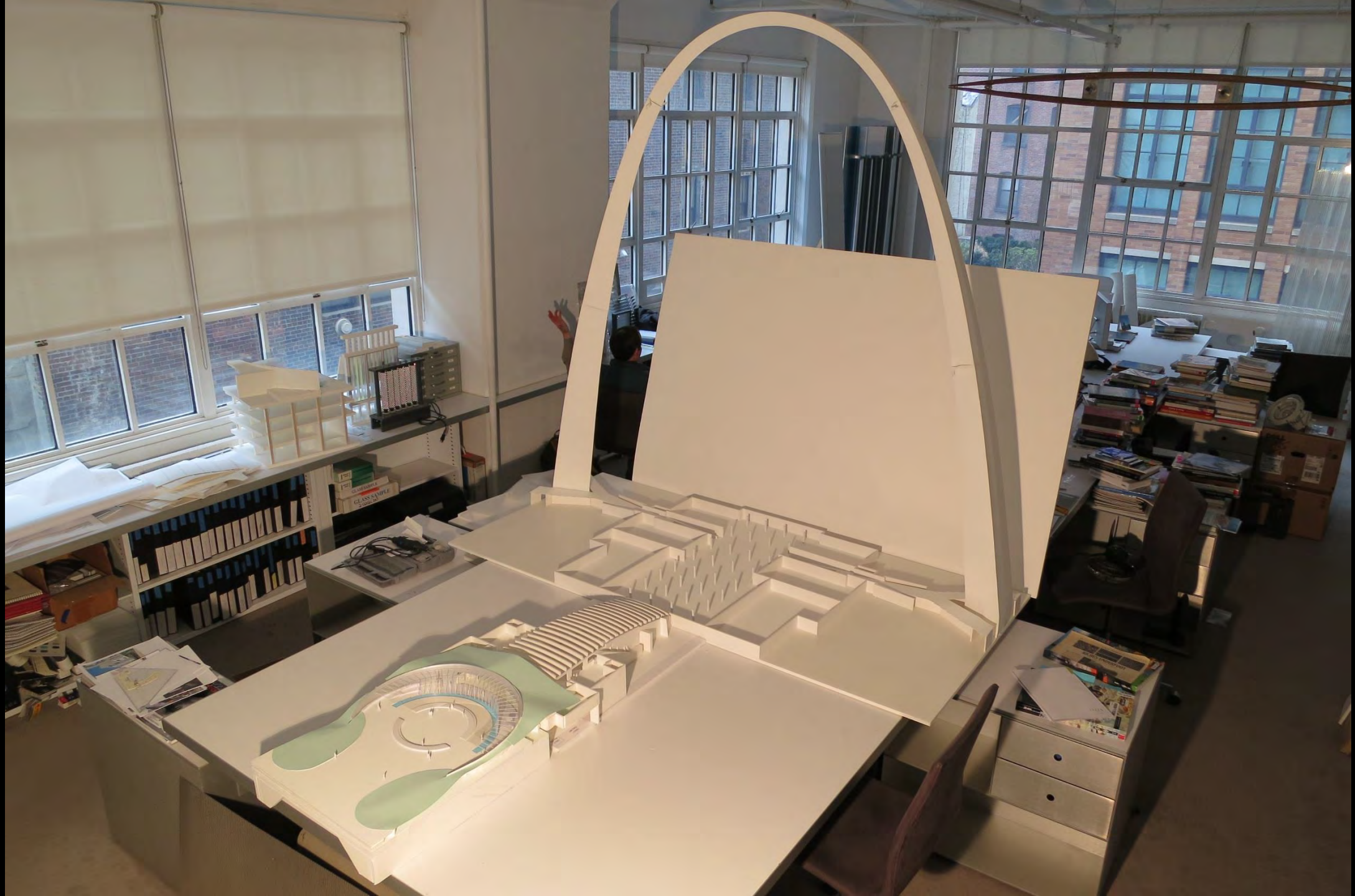

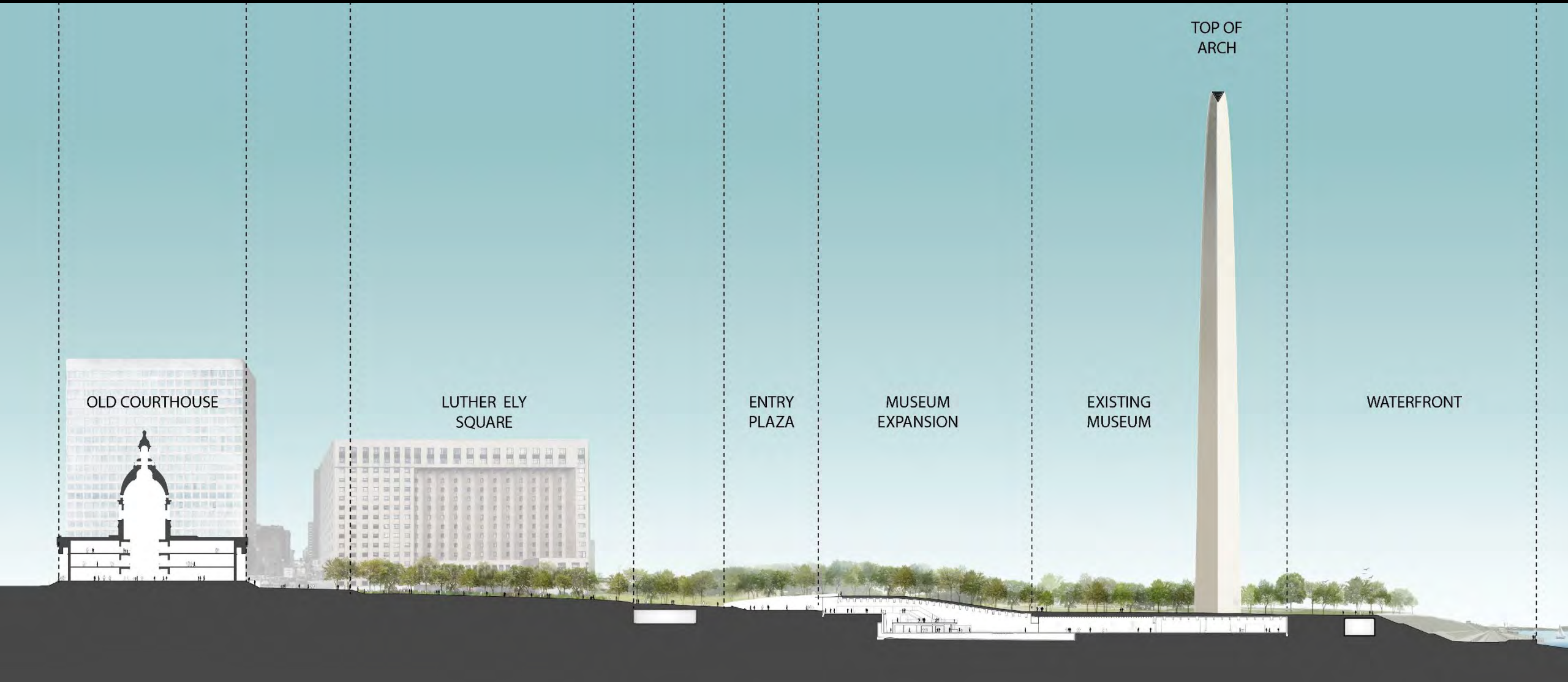

OLD COURTHOUSE

LUTHER ELY
SQUARE

ENTRY
PLAZA

MUSEUM
EXPANSION

EXISTING
MUSEUM

WATERFRONT

TOP OF
ARCH





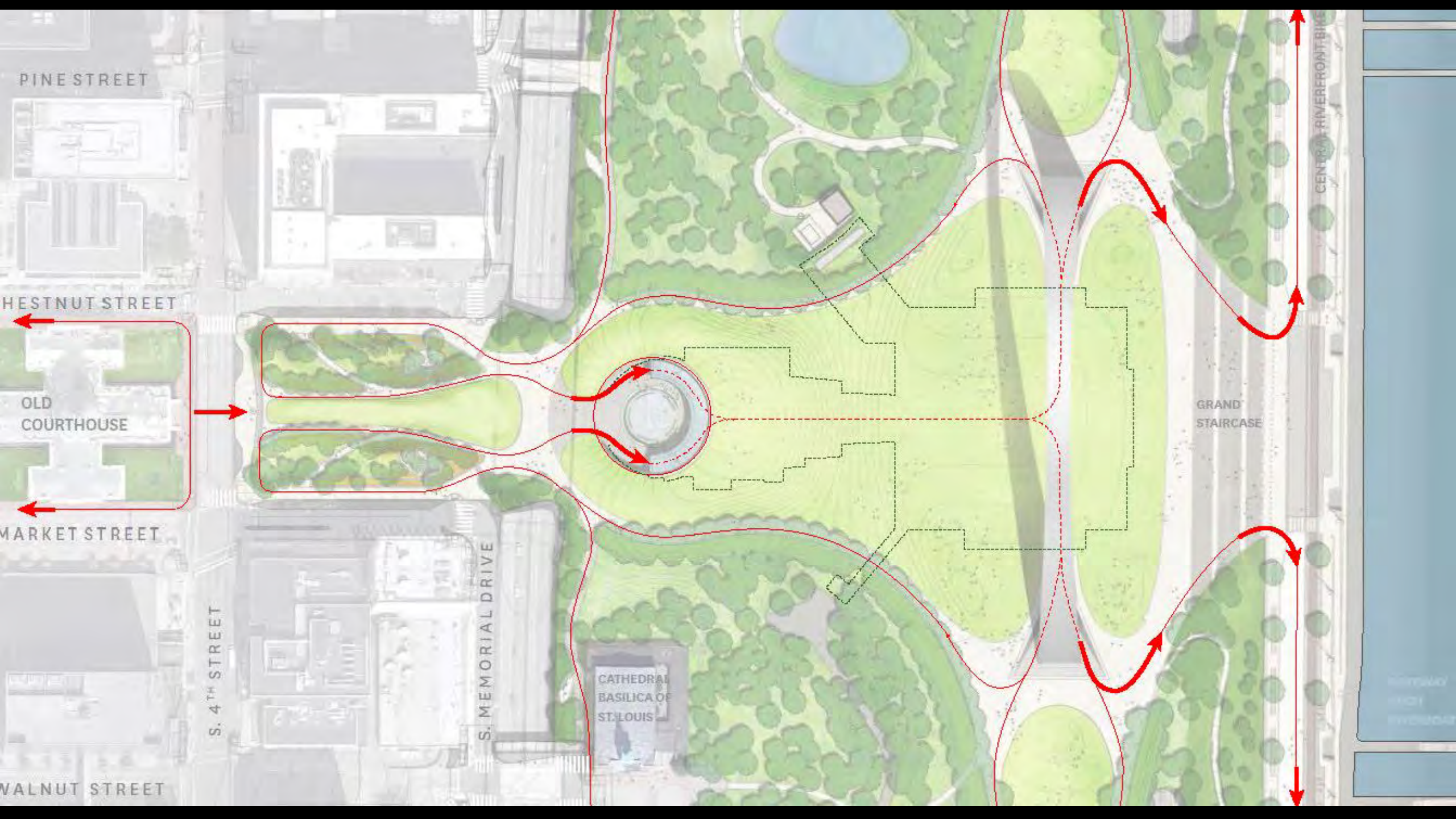

PINE STREET

CHESTNUT STREET

OLD COURTHOUSE

MARKET STREET

WALNUT STREET

S. 4TH STREET

S. MEMORIAL DRIVE

CATHEDRAL
BASILICA OF
ST. LOUIS

GRAND
STAIRCASE

CENTRAL RIVERFRONT BLDG

RAILROAD
VIADUCT
RAILROAD





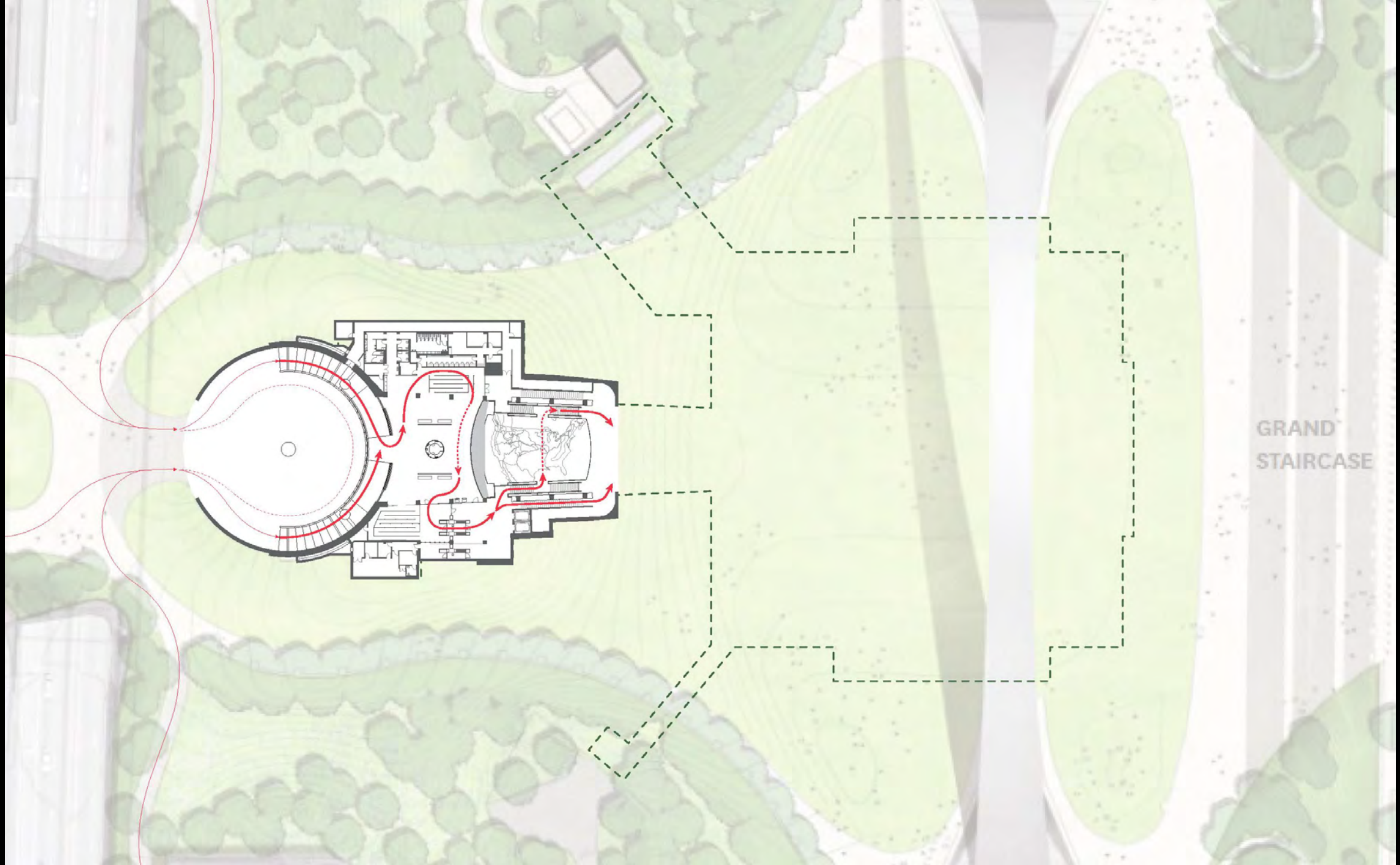

GRAND
STAIRCASE



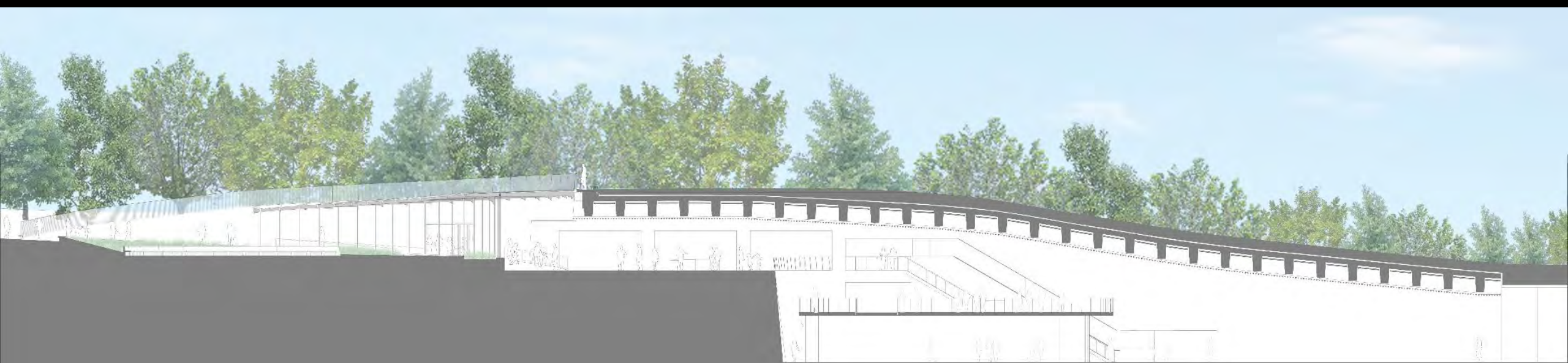



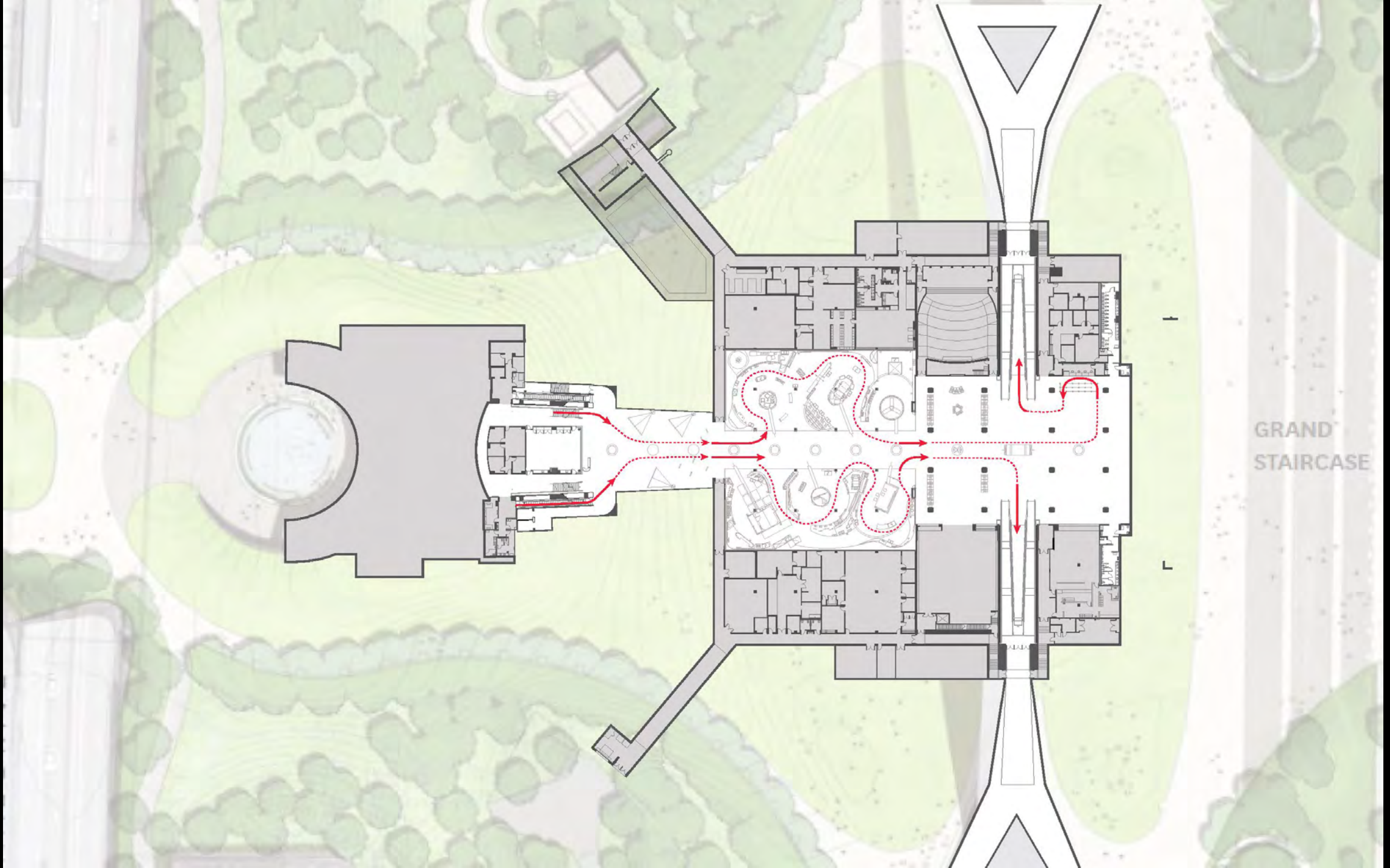

GRAND
STAIRCASE

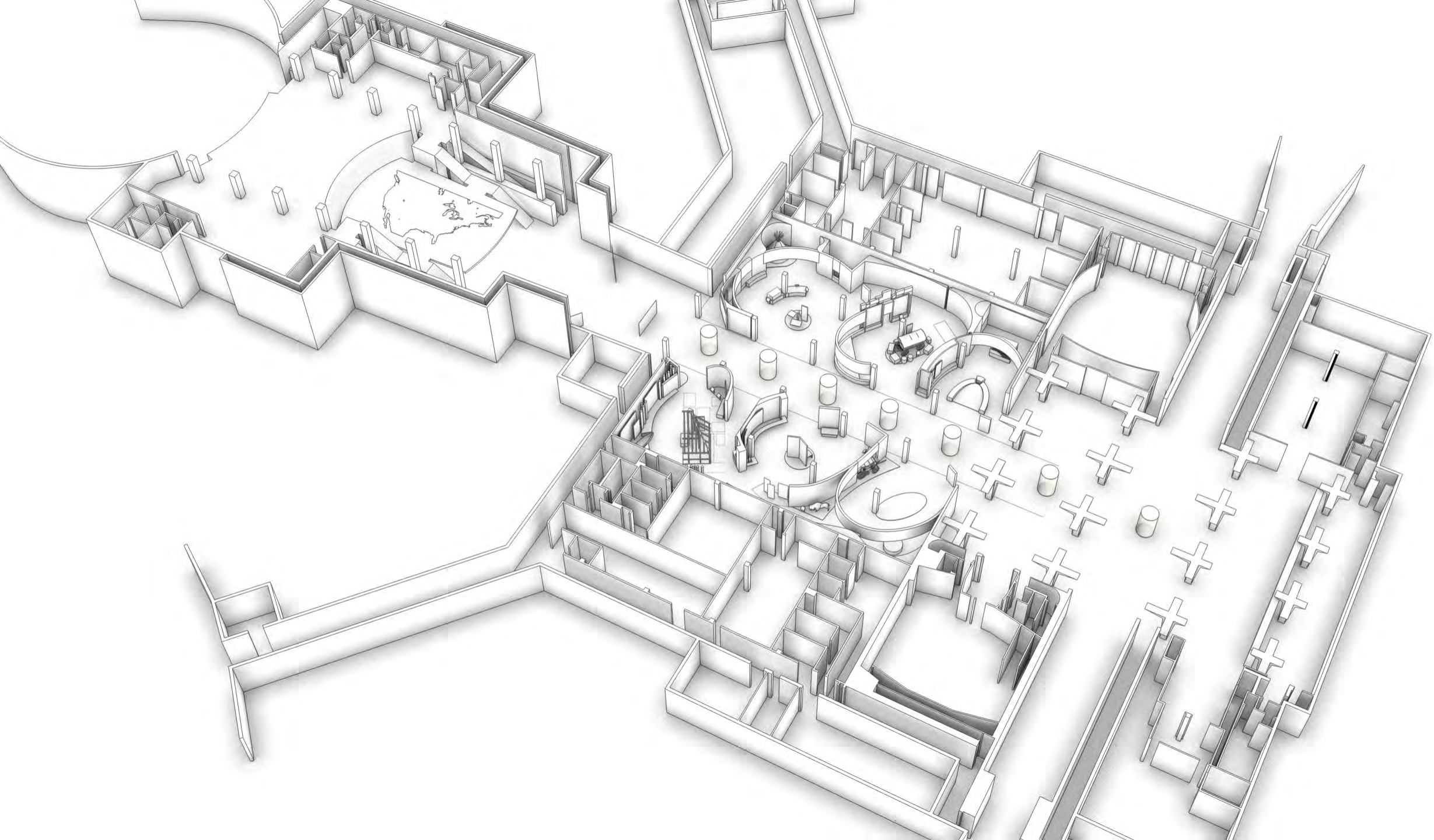





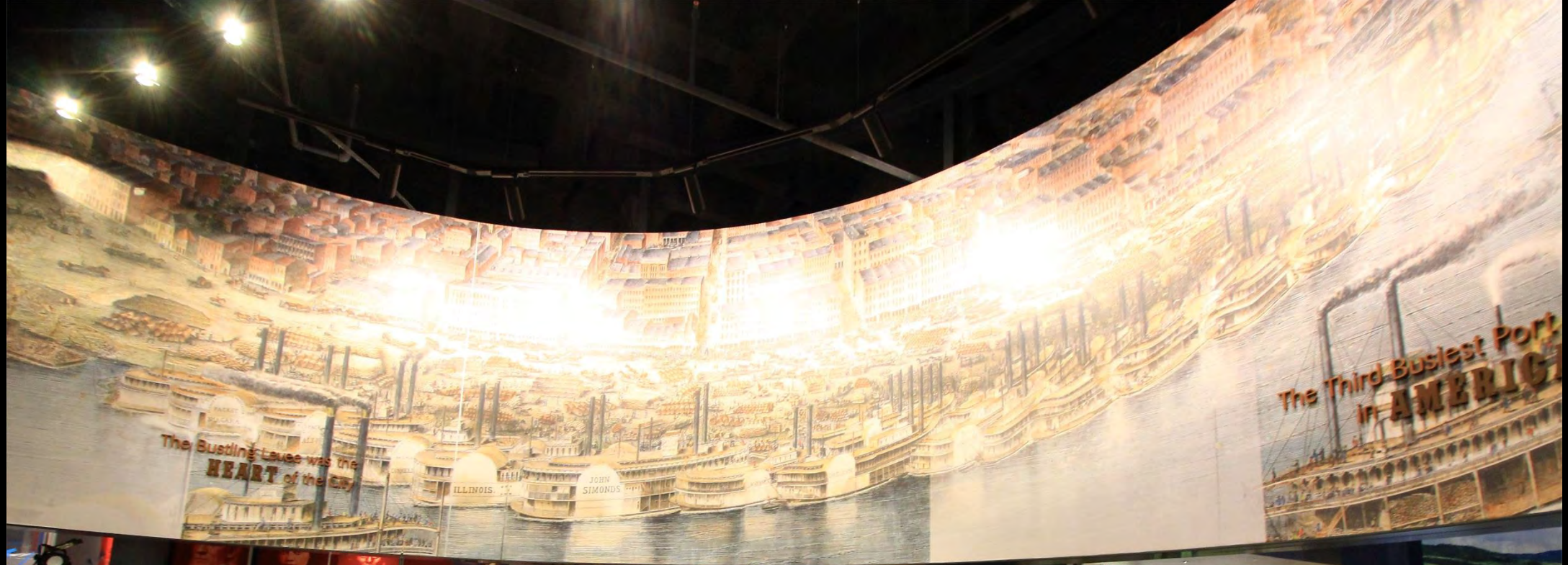

JUNE 1, 1945

Building the portion of the Arch that would be the top of the legs. The two legs were set in place, and the top of the legs were set in place. The two legs were set in place, and the top of the legs were set in place.

DETERMINATION

October 28, 1965
The final section was set in place, completing the Arch.

The two 630-foot tall legs leaned toward one another with tremendous force, and stood just two feet apart. Into this gap the eight-foot wide final piece, weighing 10 tons, had to be inserted. Huge jacks exerted 500 tons of pressure to open the gap to 8½ feet.

INCORPORATING THE ARCH INTO THE INTERPRETIVE PROGRAM

